

**Operating Instructions
for
Rotor flow Indicator**

Model: DKF



1. Contents

1. Contents.....	2
2. Note	3
3. Instrument Inspection.....	3
4. Regulation Use	3
5. Mechanical Connection.....	4
5.1 Before installation	4
6. Technical Information.....	4
7. Order Codes	5
8. Dimensions	5
9. Disposal	6
10. EU Declaration of Conformance	7
11. UK Declaration of Conformity.....	8

Manufactured and sold by:

Kobold Messring GmbH
Nordring 22-24
D-65719 Hofheim
Tel.: +49(0)6192-2990
Fax: +49(0)6192-23398
E-Mail: info.de@kobold.com
Internet: www.kobold.com

2. Note

Please read these operating instructions before unpacking and putting the unit into operation. Follow the instructions precisely as described herein.

The instruction manuals on our website www.kobold.com are always for currently manufactured version of our products. Due to technical changes, the instruction manuals available online may not always correspond to the product version you have purchased. If you need an instruction manual that corresponds to the purchased product version, you can request it from us free of charge by email (info.de@kobold.com) in PDF format, specifying the relevant invoice number and serial number. If you wish, the operating instructions can also be sent to you by post in paper form against an applicable postage fee.

The devices are only to be used, maintained and serviced by persons familiar with these operating instructions and in accordance with local regulations applying to Health & Safety and prevention of accidents.

When used in machines, the measuring unit should be used only when the machines fulfil the EC-machine guidelines.

as per PED 2014/68/EU

In acc. with Article 4 Paragraph (3), "Sound Engineering Practice", of the PED 2014/68/EU no CE mark.

Diagram 8, Pipe, Group 1 dangerous fluids

3. Instrument Inspection

Instruments are inspected before shipping and sent out in perfect condition.

Should damage to a device be visible, we recommend a thorough inspection of the delivery packaging. In case of damage, please inform your parcel service / forwarding agent immediately, since they are responsible for damages during transit.

Scope of delivery:

The standard delivery includes:

- Rotor Flow Indicator: Model: DKF

4. Regulation Use

Any use of the Rotor Flow Indicator, model: DKF, which exceeds the manufacturer's specifications, may invalidate its warranty. Therefore, any resulting damage is not the responsibility of the manufacturer. The user assumes all risk for such usage.

5. Mechanical Connection

5.1 Before installation

- Remove all packing materials and transport restraints and ensure that no such materials remain in the device.
- Make sure that the maximum operating pressure and temperature of the device are not exceeded. (see section 6. Technical Information..)
- Install the flow indicator in the piping system, ensuring that the piping is rigidly supported at the inlet and outlet of the unit with pipe clamps
- Ensure that the piping is aligned with the inlet and outlet fittings and the no piping induced stresses are exerted in the indicator. This stress can result in damage to the device during system operation
- Protect the device from external damage.
- Avoid pressure surges within the indicator chamber, such as those arising from fast start up/shut off of flow or pulsating flow.
- If possible, after completing the mechanical installation, check the threaded connection between the device and the piping for leakage immediately.

6. Technical Information

Maximum Temperature: 120 °C
Maximum Pressure: 6 bar

Materials:

	DKF-11...	DKF-21...
Housing:	brass (MS-58)	brass (MS-58)
Glass dome:	Borosilicate glass	Borosilicate glass
Rotating vane:	POM	PTFE
Axle:	brass (MS-58)	brass (MS-58)
Sealing:	EPDM	Viton
Rings:	brass (MS-58)	brass (MS-58)
Screws:	st. steel	st. steel

7. Order Codes

Order data (Example: DKF-1101H R06)

Indication range		Model		Connection	
l/min water	ΔP (bar)*	DKF-11..	DKF-21..	G-thread	NPT-thread
0.14 - 2	1	DKF-1101H..	DKF-2101H..	R06	N06
0.25 - 7	1	DKF-1102H..	DKF-2102H..	R08	N08
0.45 - 18	1	DKF-1103H..	DKF-2103H..	R10	N10
0.6 - 28	1	DKF-1104H..	DKF-2104H..	R15	N15
1 - 61	1	DKF-1105H..	DKF-2105H..	R20	N20
1.8 - 83	1	DKF-1106H..	DKF-2106H..	R25	N25

* max. flow

8. Dimensions

Model	p_{max}	t_{max}	G	NPT	L1	L	A	B	Weight kg
DKF-..01H	6 bar	120 °C	G 1/8	1/8"	8	56	41	50	0.3
DKF-..02H	6 bar	120 °C	G 1/4	1/4"	10	56	41	50	0.28
DKF-..03H	6 bar	120 °C	G 3/8	3/8"	14	73	53	67	0.57
DKF-..04H	6 bar	120 °C	G 1/2	1/2"	14	73	53	67	0.54
DKF-..05H	6 bar	120 °C	G 3/4	3/4"	16	109	72	94	1.41
DKF-..06H	6 bar	120 °C	G 1	1"	18	109	72	94	1.30

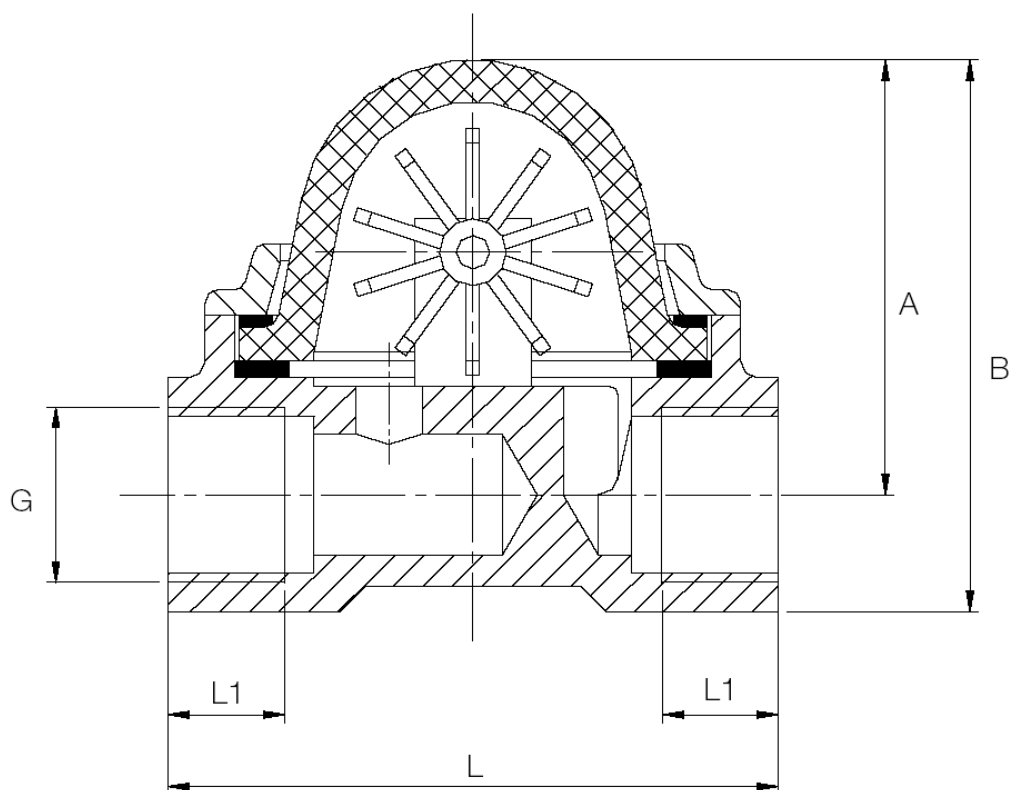

9. Disposal

Note!

- Avoid environmental damage caused by media-contaminated parts
- Dispose of the device and packaging in an environmentally friendly manner
- Comply with applicable national and international disposal regulations and environmental regulations.

Batteries

Batteries containing pollutants are marked with a sign consisting of a crossed-out garbage can and the chemical symbol (Cd, Hg, Li or Pb) of the heavy metal that is decisive for the classification as containing pollutants:

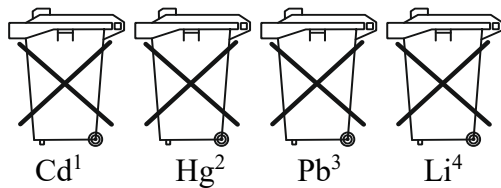

1. „Cd" stands for cadmium
2. „Hg" stands for mercury
3. „Pb" stands for lead
4. „Li" stands for lithium

Electrical and electronic equipment

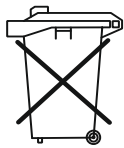

10. EU Declaration of Conformance

We, KOBOLD Messring GmbH, Hofheim-Ts, Germany, declare under our sole responsibility that the product:

Rotor Flow Indicator

Model: DKF

to which this declaration relates is in conformity with the standards noted below:

EN IEC 63000:2018 Technical documentation for the assessment of electrical and electronic products with respect to the restriction of hazardous substances

Also, the following EC guidelines are fulfilled:

2011/65/EU
2015/863/EU

RoHS (category 9)
Delegated Directive (RoHS III)



H. Volz
General Manager



M. Wenzel
Proxy Holder

Hofheim, 06 Oct. 2021

11. UK Declaration of Conformity

We, KOBOLD Messring GmbH, Hofheim-Ts, Germany, declare under our sole responsibility that the product:

Rotor Flow Indicator

Model: DKF

to which this declaration relates is in conformity with the standards noted below:

BS EN IEC 63000:2018

Technical documentation for the assessment of electrical and electronic products with respect to the restriction of hazardous substances.

Also, the following UK guidelines are fulfilled:

S.I. 2012/3032

The Restriction of the Use of Certain Hazardous Substances in Electrical and Electronic Equipment Regulations 2012



H. Volz
General Manager



M. Wenzel
Proxy Holder

Hofheim, 06 Oct. 2021